

SATELLITE 760-6 MkII

SAFETY & OPERATORS MANUAL

& PARTS LISTING

19-11-12

CAUTION: Read the instruction manual before using the appliance.



DESIGNED & BUILT IN AUSTRALIA

SATELLITE 760-6 MkII

Table of contents

PAGE 1.	Table of contents
PAGE 2.	Specifications
PAGE 3.	Safety instructions
PAGE 4.	Safety instructions
PAGE 5.	Operating instructions
PAGE 6.	Operating instructions cont...
PAGE 7.	Handle Positions
PAGE 8.	Tooling position & Magnetic Inserts
PAGE 9.	Axle height adjustment
PAGE 10.	Electrical safety
PAGE 11.	Problem solving
PAGE 12.	Wiring Diagram
PAGE 13.	Main Parts breakdown
PAGE 14.	Ratchet Handle Breakdown
PAGE 15.	Main Electrical Box Breakdown
PAGE 16.	Control Box Breakdown
PAGE 17.	Disk Breakdown
PAGE 18.	Parts listing
PAGE 19.	Parts listing

SATELLITE 760-6 MkII

Specifications

Satellite 760-6 MkII	
Weight	340kg including weights
Dimensions	843 x 989 x 1586 (width x Height x Length)
Rated Voltage	400 Volt 50 Hz 3 ~
Rated Watts	8000W
Grinding Path	760mm

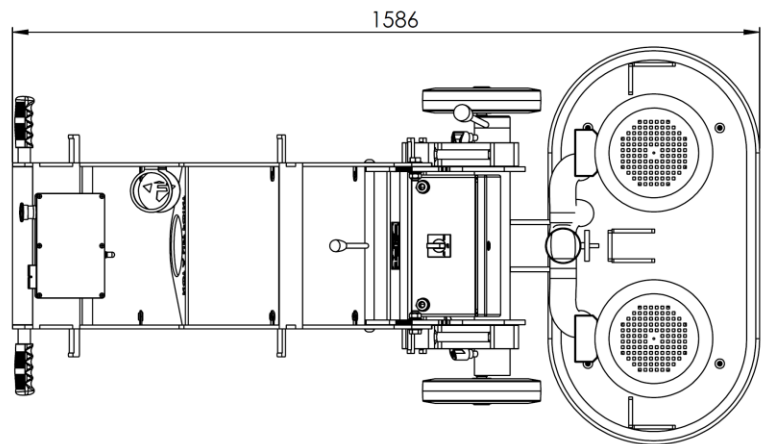
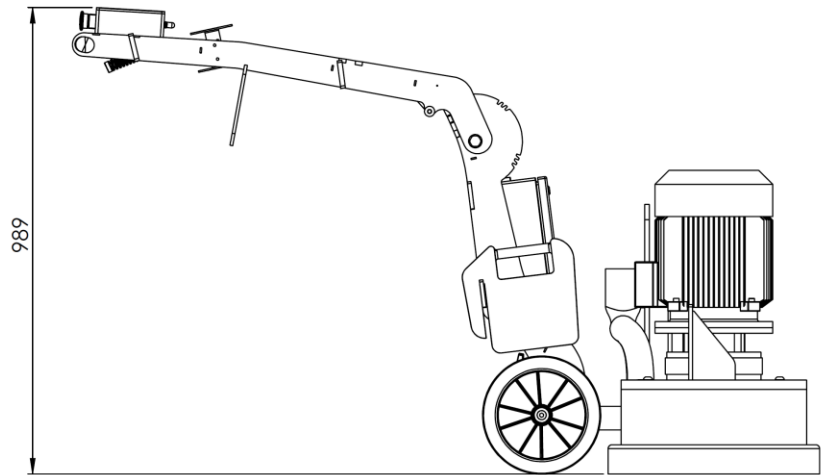
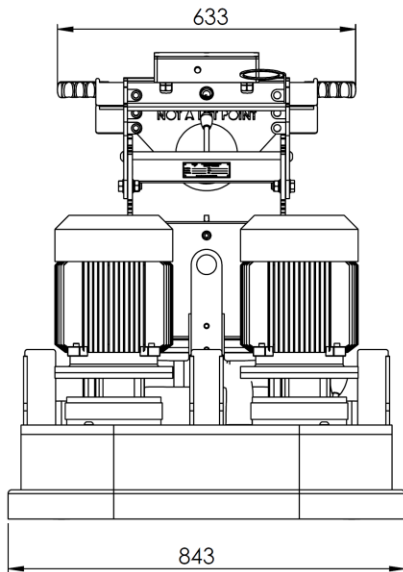

SATELLITE 760-6 MkII

Safety instructions

01. Read and understand the instructions on the machine and in this manual and engine manual (if applicable). Different models may have different parts and controls.
02. Equipment should only be operated by trained personnel, in good physical condition and mental health (not fatigued). The operator and maintenance personnel must physically be able to handle the bulk weight and power of this machine.
03. The SATELLITE 760-6 MkII must only be used according to the instructions given in this manual. Any other work methods or practices could result in injury or death
04. The SATELLITE 760-6 MkII has different positions in which the handle can be locked into. These are described in this manual as 'OPERATE', 'TOOLING POSITION' and 'STORAGE'. See Handle Positions for diagrams of these positions. When to use and when not to use these positions is described throughout this manual
05. This is a one person machine. Maintain a safe operating distance to other personnel. Remember 'one machine, one operator'.
06. This equipment is intended for commercial use.
07. For the operators' safety and the safety of others, always keep all guards and shrouds in place.
08. The weights are there to assist the machine in operation. Always remove them from the handle before folding it to the 'TOOLING POSITION' or 'STORAGE' positions.
09. Never start or run machine when it is unattended.
10. Check for wear on magnetic plugs and inserts every 3 hours of use.
11. This machine is only intended for use on floor surfaces such as concrete, terrazzo and other hard floor surfaces.
12. The handle height is adjustable with different positions for operator comfort. These positions are shown next to the locking mechanism as 'OPERATE'. The SATELLITE 760-6 must never be started or used with the handle in any other position other than the 'OPERATE' positions.
13. Never attempt to adjust the handle position when the machine is in operation.
14. Never start or run machine with the handle folded or when disk(s) are not in contact with the surface.
15. Do not lend or rent machine without the operating and safety instructions for the machine (and the engine, if applicable).
16. Wear clothing suitable for the job and for the work place including, safety shoes, hard hat, hearing protection, non-fogging vented safety goggles, and dust mask suitable for dust.
17. Keep body parts or any loose clothing away from moving parts. Failure to comply could result in bodily injury.

SATELLITE 760-6 MkII

Safety instructions

18. Do not modify machine in any way. Only use genuine SATELLITE parts and accessories.
19. Repairs should be performed by qualified persons only.
20. Ensure parts have stopped moving and disconnect power or spark plug before moving the Handle to the 'TOOLING POSITION' or 'STORAGE' positions and when servicing or changing blades or accessories.
21. Never operate machine in rain or if heavy moisture is present.
22. Petrol is extremely flammable and poisonous. Petrol should only be dispensed in well ventilated areas, and only when engine is cool.
23. **WARNING! POISONOUS EXHAUST GASES.** Do not operate petrol powered equipment, including generators, without adequate ventilation. Carbon monoxide is an invisible odorless gas that can harm or can kill.
24. Do not operate SATELLITE 760-6 with any covers or doors removed or open.
25. The SATELLITE 760-6 can produce sound pressure levels greater than 85db. The operator must wear approved safety ear protection.
26. Do not allow the supply cord to come in contact with the cutting blade/head or other moving parts of this machine.

SATELLITE 760-6 MkII

Operating Instructions

01. Wear clothes suitable for the job and for the work place including, safety shoes, hard hat, hearing protection, non-fogging vented safety goggles, and dust respirator suitable for dust.
02. The SATELLITE 760-6 MkII must only be used according to the instructions given in this manual. Any other work methods or practices could result in injury or death
03. Ensure parts have stopped moving and disconnect power or spark plug before moving the Handle to the 'TOOLING POSITION' or 'STORAGE' positions and when servicing or changing blades or accessories.
04. **WARNING! POISONOUS EXHAUST GASES.** Do not operate petrol powered equipment, including generators, without adequate ventilation. Carbon monoxide is an invisible odorless gas that can harm or can kill.
05. Be sure all equipment is tested and tagged prior to use on any job.
06. Inspect entire area to be ground before grinding and remove any bolts or concrete nails (etc) that could damage tooling or the machine and which could cause a hazardous situation.
07. Ensure there are no obstacles or existing structures that could present a hazard to the operator. If so, take necessary action to eliminate the hazard.
08. Fold handle to the 'TOOLING' position and ensure it is locked in place, then tilt machine back so handle is resting along the floor. See section 'HANDLE POSITIONS' for illustrations on how to remove and install tooling etc.
09. The machine takes a set of six (6) tools. Be sure the tools are of even height.
10. Install appropriate diamond tooling or other available tooling into the machine. Only use genuine SATELLITE tooling. Failure to comply could result in bodily injury.
11. Tilt machine back onto the disk and put the handle in one of the 'OPERATE' positions. Adjust the position to one that you are comfortable with.
12. Never attempt to adjust the handle position when the machine is in operation.
13. The SATELLITE 760-6 MkII has axle height adjustment to level the machine. Set the level bubble to the center before you start the machine each time. Particularly after you have installed new diamond tooling
14. Connect machine to suitable power outlet. Only use heavy duty power lead suitable for high current use (preferably 2.5mm² cable), no longer than 15 meters.
15. If no power is available within the specified distance, have a qualified person install a suitable power outlet closer to your work. Alternatively use 4mm² cable for up to 40 meters.
16. Connect a suitable dust extractor to the machine via a 50 or 75mm flexible hose. The machine is designed to take the standard 50mm hose ends to make connection of dust extractors easy and hassle free.
17. Keep machine clear of drainage pits, grates, steps or major lips or such hazard. Failure to comply could result in bodily injury and or could damage the machine or property.
18. Ensure machine is on a level surface and handle is in one of the 'OPERATE' positions
19. This machine is designed to operate with the wheels in contact with the floor at all times. Do not operate with wheels off the floor.
20. Switch on the dust extractor.

Operating Instructions cont...

21. Hold the handles firmly and switch the Satellite 760-6 on by pushing the green button.
22. The controls on the Satellite 760-6 include an over load devices. They are there to protect the controls and motor from irreparable damage. If they trip it indicates a problem. (i.e.; undersize power lead or poor power to the wall socket). Refer earlier in this section for recommendations on power leads. Rectify the problem or decrease load on the Satellite 760-6 by using tooling with more surface area, or place weights supplied on the brackets on handle for this purpose.
23. Continuing to use the Satellite 760-6 when constant tripping occurs, **VOIDS THE WARRANTY.**
24. Do not attempt to make any adjustments while the machine is in operation. Any adjustments must only be performed when machine is stopped and power disconnected.
25. This machine is designed to operate with the wheels in contact with the floor at all times. Do not operate with wheels off the floor.
26. After a few minutes of grinding check the wear of the diamond tooling. This will pay handsomely if the diamonds are wearing out fast due to soft concrete / abrasive concrete. There is a wide range of diamonds available to suit every need.
27. Check for wear on magnetic plugs and inserts every 3 hours of use
28. See Section 'PROBLEM SOLVING' for tips on how to grind faster on tough concrete and how other problems can be rectified.
29. **WARNING!** As with any diamond tooling, breathable silica may be generated by use and maintenance of this machine. Silica can cause severe and permanent lung damage, cancer, and or other serious diseases. Do not breathe the dust. Do not rely on your sight or smell to determine if dust is in the air. Silica may be in the air without a visible dust cloud. If air monitoring for silica is not provided by your employer at your work site, you must wear appropriate respiratory protection when operating or maintaining this equipment. Consult your employer for proper respiratory protection.

SATELLITE 760-6 MkII

Handle Positions

01. The handle on this machine can be locked in different positions for different purposes. These positions must only be used for the purpose intended as outlined in this manual. Failure to comply could result in bodily injury.
02. These positions are shown below and when and where to use them is outlined throughout the manual

03.

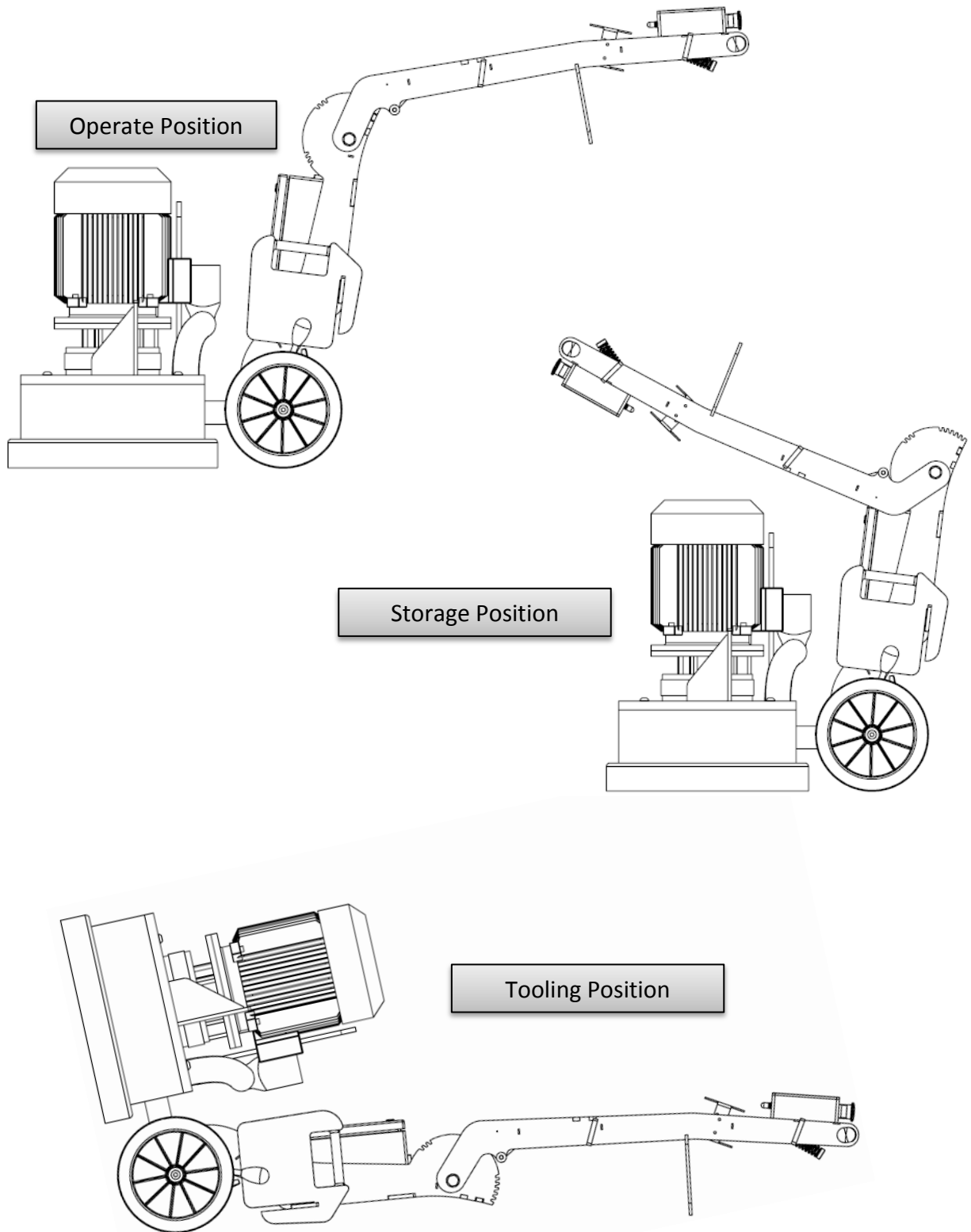

Tooling removal & Magnetic Inserts

01. To remove tooling from the magnetic plugs, Move the handle to the 'TOOLING POSTION' and tilt the machine as per instructions in the operating instructions and grasp hold of the diamond disk and give it a sharp tug away from the main black disk.
02. To remove the plug from the main black disk strike the black disk beside the plug as shown below.



03. The magnetic insert must be cleaned every time the insert is removed.
04. Ensure the insert is not worn more than 30% through where the blade runs on the insert
05. Clean out the hole in the magnetic adapter where the insert goes. Ensure there are no particles or pieces of steel (such as staples ETC).
06. Refit the insert on the blade and slide them onto the magnetic adapter ensuring the insert goes completely into the plug

Axle height adjustment

01. This machine is designed to operate with the wheels in contact with the floor at all times. Do not operate with wheels off the floor.
02. The axle lever must be set so the level bubble, located near the lift point is centered.

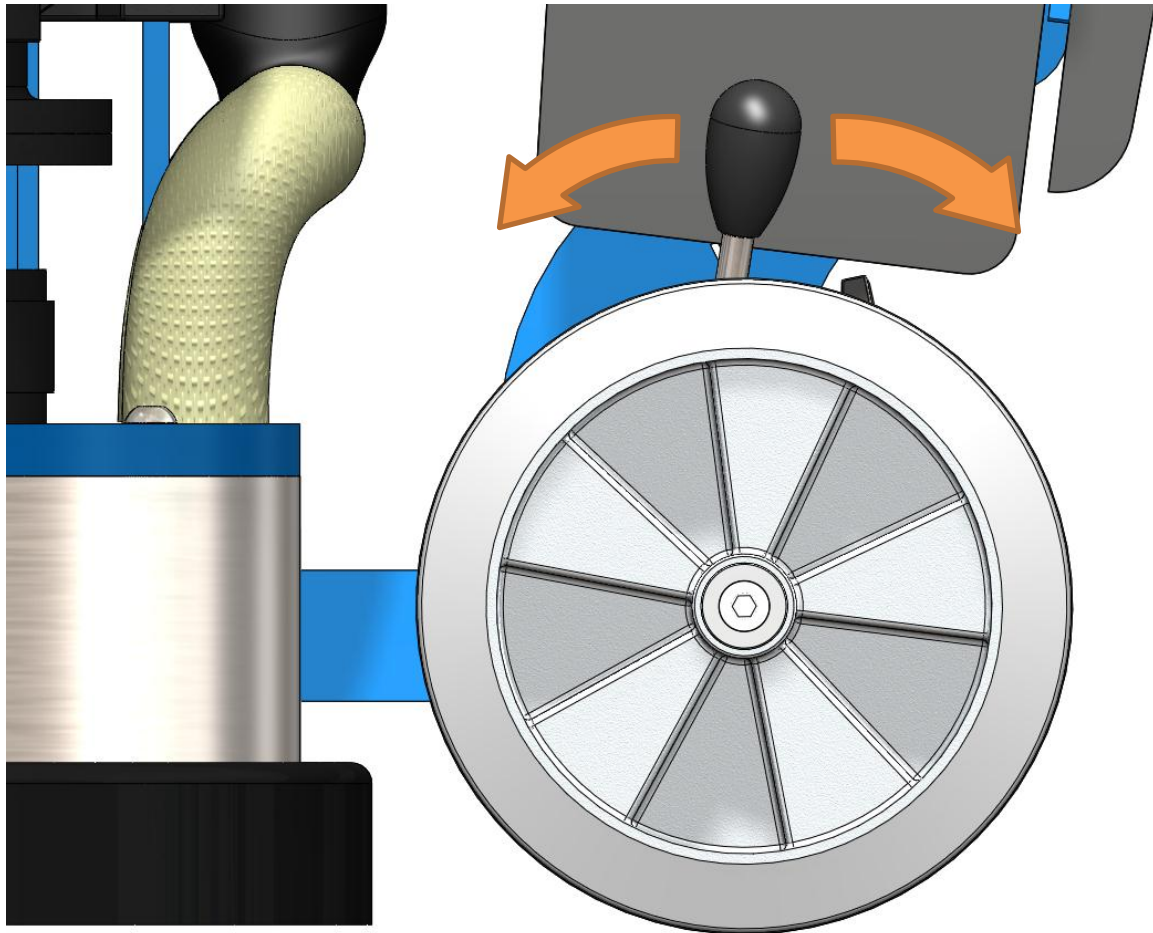

SATELLITE 760-6 MkII

Electrical safety

01. All electrical maintenance and repairs are to be carried out by qualified persons only.
02. CAUTION - Line terminals may be alive when main switch is in the off position. Disconnect the machine completely before performing any maintenance or repairs.
03. WARNING - DO NOT operate the machine with any electrical panels open.
04. WARNING -The controls on the Satellite 760-6 include an over load devices. They are there to protect the controls and motor from irreparable damage. If they trip it indicates a problem. (i.e.; undersize power lead or poor power to the wall socket). Refer earlier in this section for recommendations on power leads. Rectify the problem or decrease load on the Satellite 760-6 by using tooling with more surface area, or place weights supplied on the brackets on handle for this purpose.
05. Continuing to use the Satellite 760-6 when constant tripping occurs, VOIDS THE WARRANTY!
06. Never operate machine in the rain or if heavy moisture is present.
07. The overload is there to protect you and the machine from harm. DO NOT bypass or adjust the over load in any way. If it is faulty, only replace with original part that is identical to the faulty one.
08. Never bypass over current devices in this machine.
09. Never connect or disconnect power cables with voltage present or while under load.
10. Disconnect all power connections and observe lock out / tag out procedures before attempting to carry out any maintenance or repair on any equipment.
11. Avoid any contact with any rotating parts or driven parts.
12. Never use equipment that has not been tested and tagged (including cords).
13. Before connecting the machine to power, check the condition of all power leads and cables on, or used in conjunction with the machine. DO NOT USE it if any faults, cuts, wear marks, etc... Get qualified persons to repair and re-tag it as required by regulations in your country.
14. Connect machine to suitable power outlet. Only use heavy duty power lead suitable for high current use (preferably 2.5 mm² cable), no longer than 15 meters.
15. If no power is available within the specified distance have a qualified person install a suitable power outlet closer to your work. Alternatively use 4 mm² cable for up to 40 meters.
16. Do not operate Satellite 760-6 with any covers or doors removed or open.

SATELLITE 760-6 MkII

Problem solving

Diamond Grinding has many variables. When you understand some of these, you can solve a lot of problems without a lot of bother and expense.

PROBLEM	CAUSE	REMEDY	EXPLANATION
Machine will not start / run.	No power is present at cable end.	Check the power is present with another tool.	Using another tool confirms power is present
	Machine is trying to start on glue or other sticky substance.	Clear a patch with a scraper and grind into the glue a little at a time.	This means it only tackles a small amount of glue at a time and keeps the glue residue coated with dust, preventing glue sticking and building up on the diamonds.
	Power lead is too small in capacity or too long.	Upgrade the power lead to 2.5mm ² (15meters max) or 4mm ² (40 meters max).	The long / small capacity cable is too restrictive and can't allow enough power through for the machine to start / run properly.
		Use weights on the handle.	The weight on the handle reduces the load on the machine thus reducing the current.
Machine is not grinding at all.	No blades / accessories in unit.	Fit blades. Note; check wear on machine.	
	Very hard concrete or glazed topping on concrete.	Turn dust extractor down / restrict flow. Only just control the dust from escaping.	The extra dust accumulating on the floor acts as an abrasive between the segments and the floor thus exposing the diamonds better.
		Place river sand or cement on the floor.	The sand is an abrasive as described above.
		Use softer grade of diamond tooling.	The softer grade will expose the diamonds better.
		Use coarser diamond tooling.	The coarser diamond tooling can get through hard toppings without wearing out the diamonds too fast.
		Reverse the rotation of the machine (switch on the main control box)	The tooling exposes the diamonds when reversed. This works best when using plugs.
The diamonds are wearing out too fast.	The concrete is: *Soft *Abrasive *Rain Damaged *A rough finish (Scarified or shot blasted).	Use a powerful dust extractor to remove as much dust as possible.	The dust, as described acts as an abrasive between the segments exposing the diamonds prematurely, wasting them.
		Use harder diamond matrix.	The harder segments don't expose as easily.
		Use tooling with more segments or area ² of segment.	The tooling with more segments or area ² doesn't have the same weight on them, reducing wear.
	The diamonds are too soft or too few.	Use weights on the handle	This reduces the weight on the diamonds thus reducing the wear on them.

NOTE: THIS IS A GUIDE ONLY

SATELLITE 760-6 MkII

Wiring Diagram



Floorex Products
Concrete Preparation & Coating Systems

Model	Make	Date Draw n	Revision Number
SAT 760-12 MkII	Prepmaster	23/02/2012 15:18	1

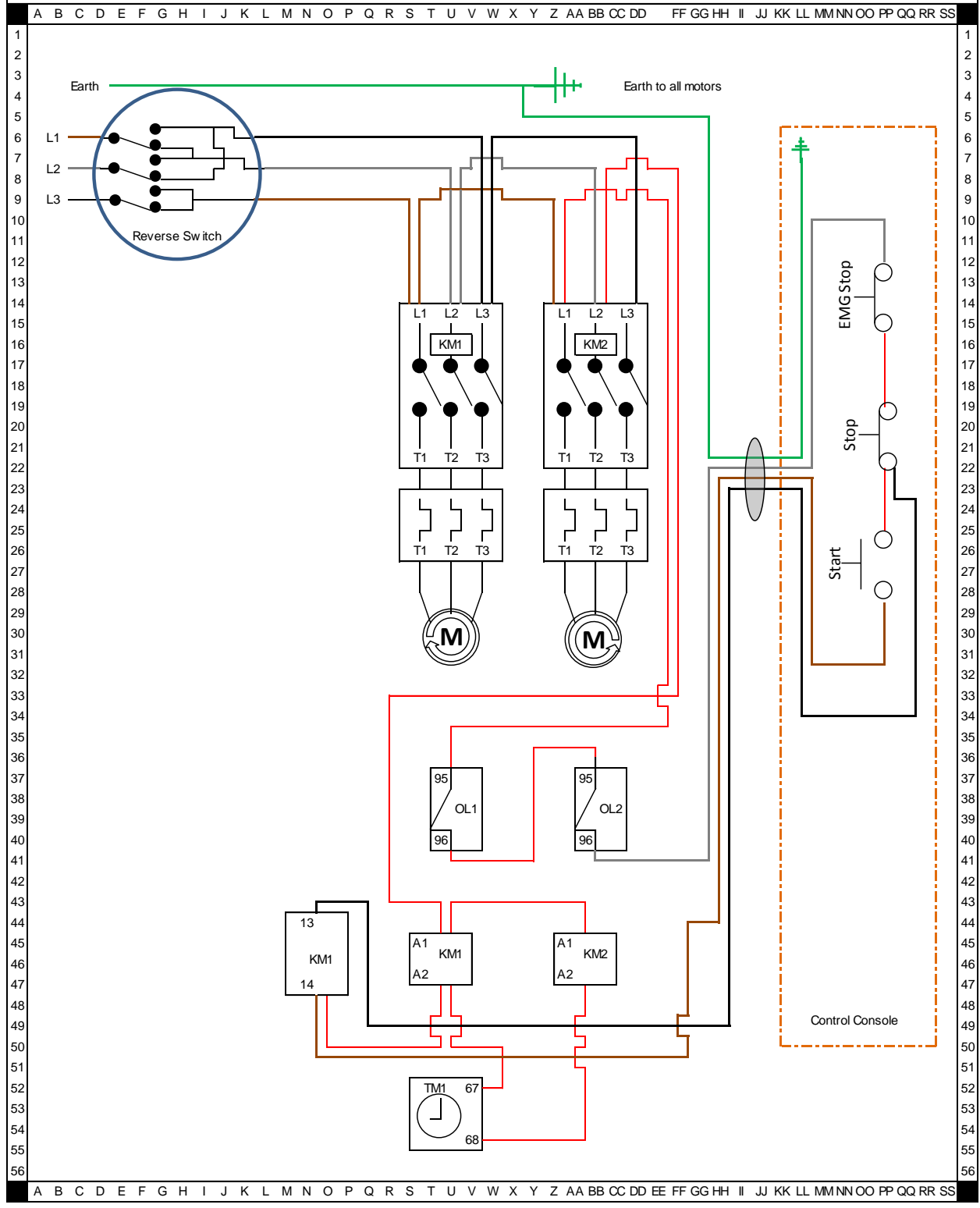

SATELLITE 760-6 MkII

Main Parts Breakdown

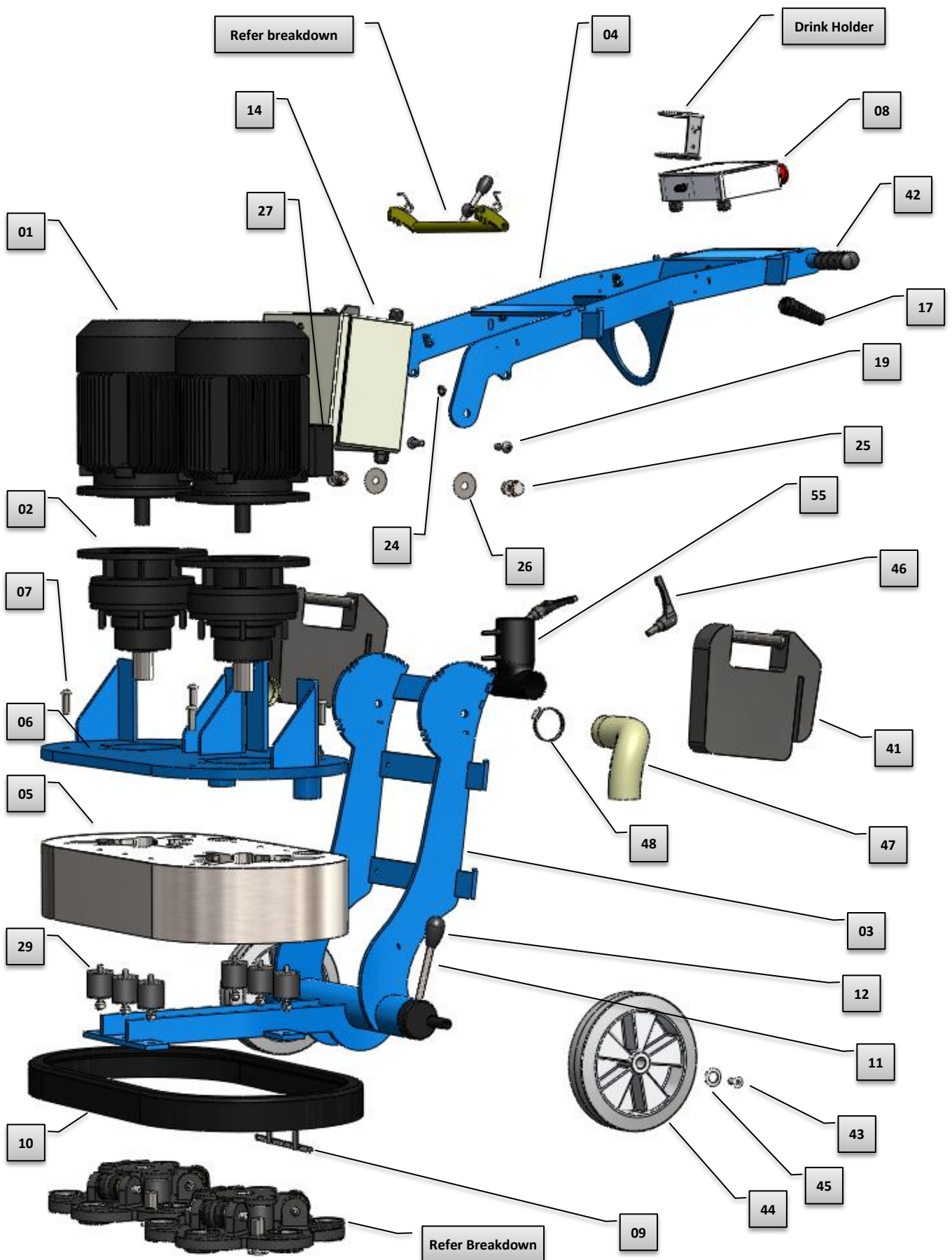

SATELLITE 760-6 MkII

Ratchet Handle Breakdown

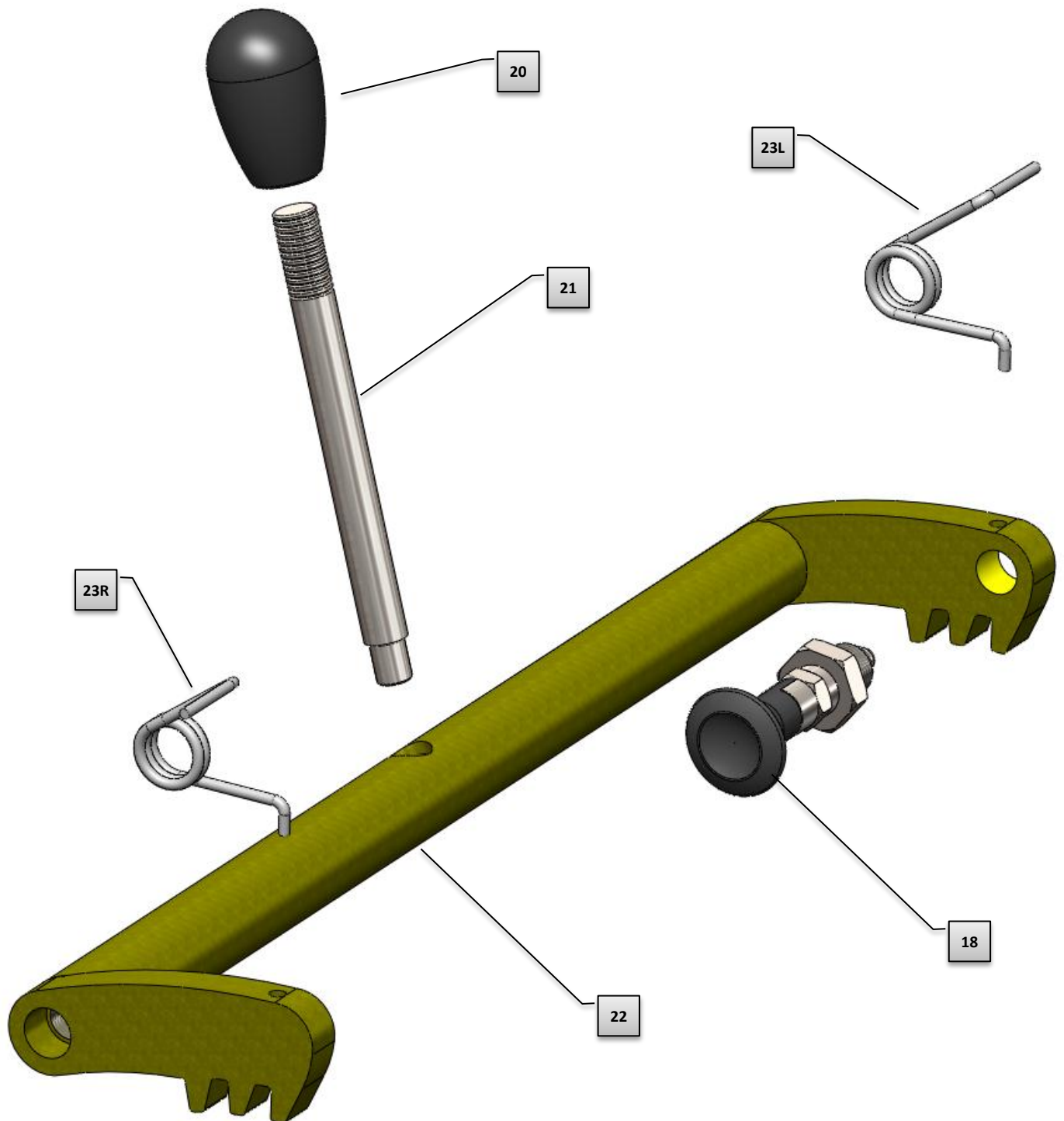

Main Electrical Box Breakdown

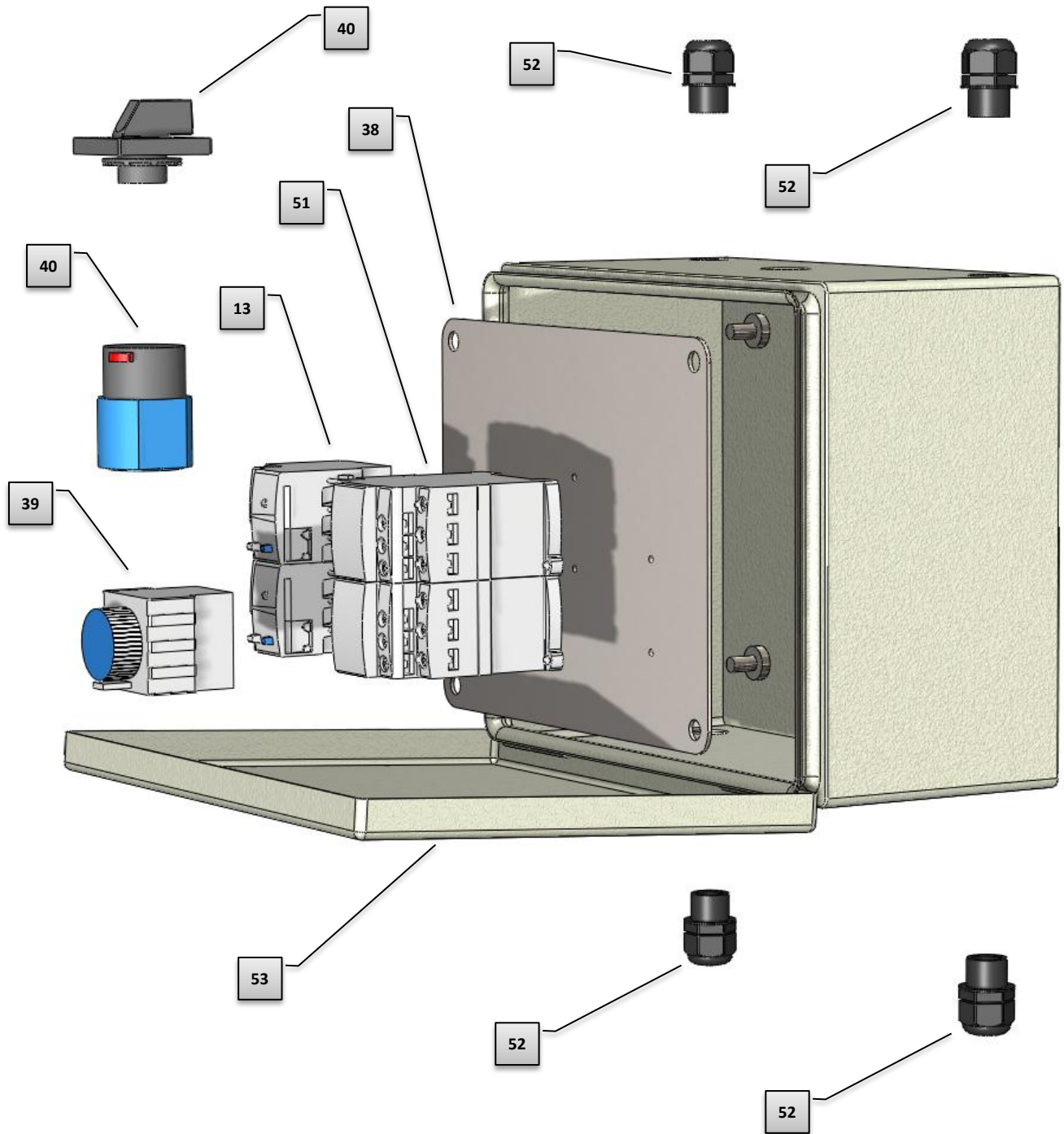

SATELLITE 760-6 MkII

Control Box Breakdown

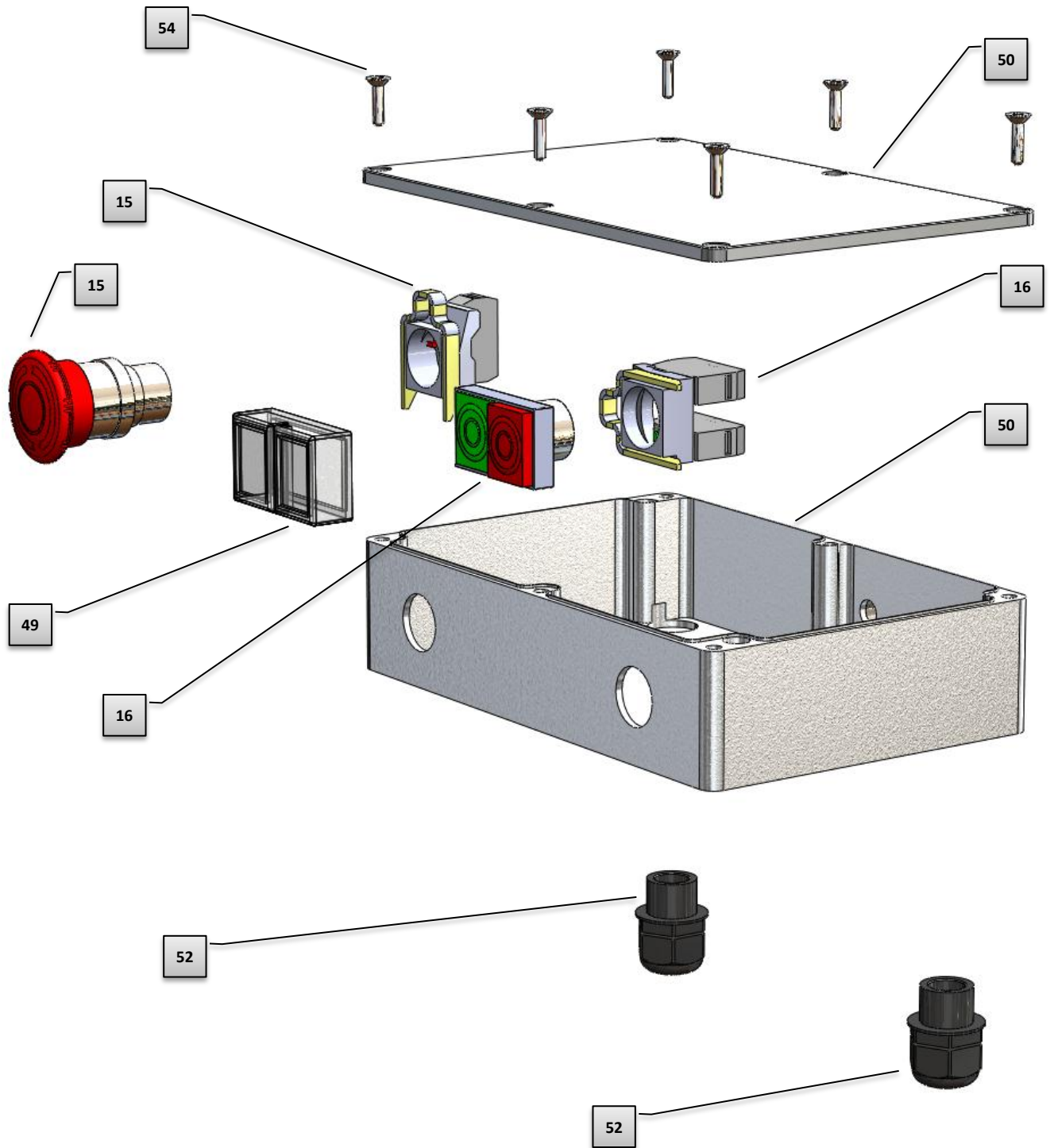

SATELLITE 760-6 MkII

Disk breakdown

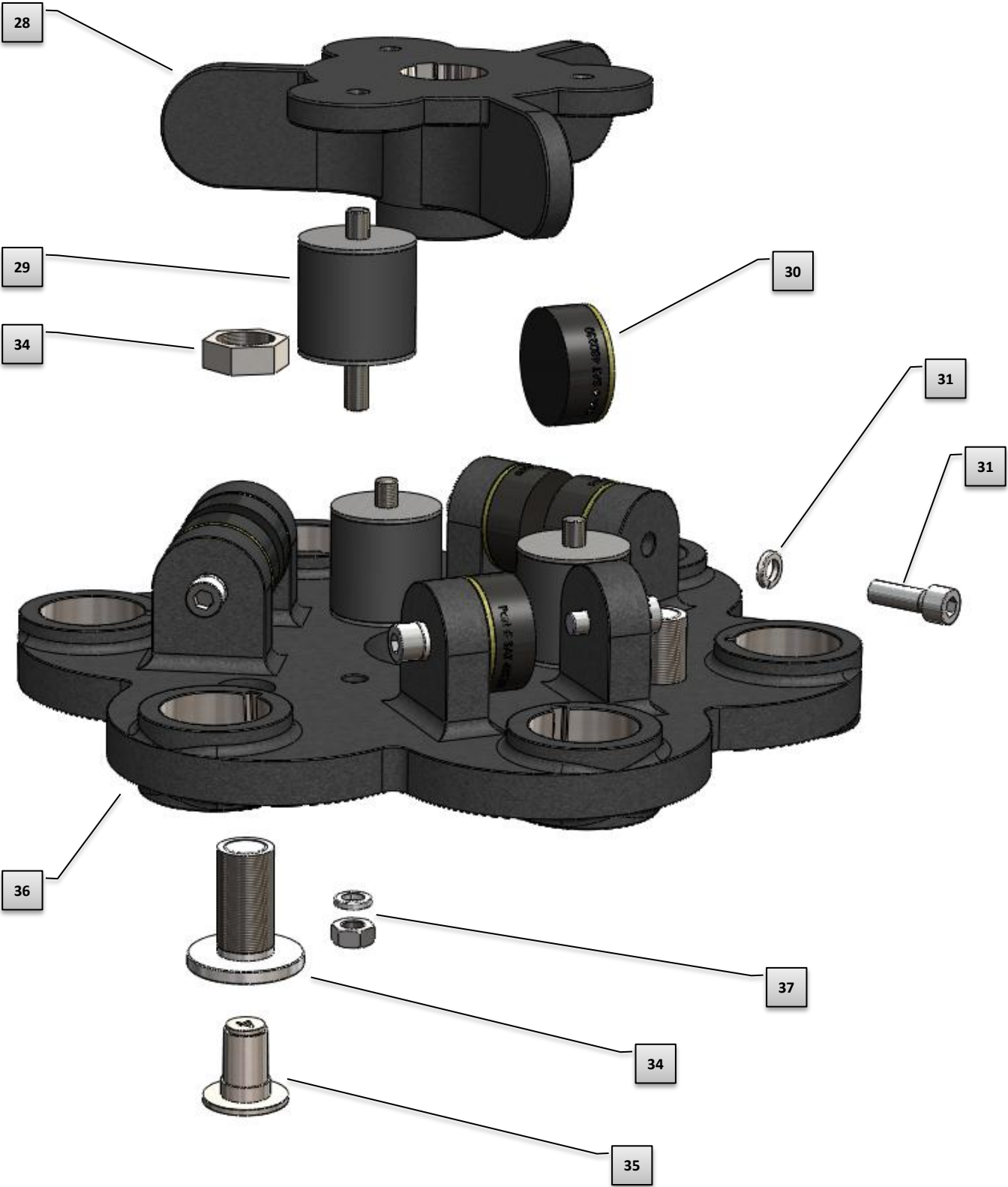

SATELLITE 760-6 MkII
Parts Listing

Item	QTY	Part No.	Description
01	2	SAT-7606201	Motor 4.0Kw
02	1	SAT-7606202	Transmission 6:1
03	1	SAT-7606203	Main Chassis
04	1	SAT-7606204	Handle
05	1	SAT-7606205	Shroud upper
06	1	SAT-7606206	Main Base Upper section
07	4	SAT-7606207	Socket Button Head M12 X 50
08	1	SAT-7606208	Control Panel box complete including switches
09	9	SAT-7606209	Shroud Link
10	1	SAT-7606210	Shroud polyurethane
11	1	SAT-7606211	Axle lever arm
12	1	SAT-7606212	Axle lever knob
13	2	SAT-7606213	Overload module 7-10amp
14	1	SAT-7606214	Main electrical box complete
15	1	SAT-7606215	Emergency stop button complete
16	1	SAT-7606216	Start stop Switch complete
17	1	SAT-7606217	Cable gland with support
18	2	SAT-7606218	Index Plunger for Handle Lock Mechanism
19	2	SAT-7606219	Socket dome head M12 x 40
20	1	SAT-7606220	Handle lever knob
21	1	SAT-7606221	handle lever arm
22	1	SAT-7606222	handle lock mechanism
23	1	SAT-7606223 L	Handle lock Spring L
23	1	SAT-7606223 R	Handle lock Spring R
24	6	SAT-7606224	Rubber Grommet
25	2	SAT-7606225	Bolt and lock nut M14 x 40
26	2	SAT-7606226	Handle Spacer .55
27	2	SAT-7606227	Motor terminal box

SATELLITE 760-6 MkII
Parts Listing

Item	QTY	Part No.	Description
28	2	SAT-7606228	Drive Hub
29	12	SAT-7606229	Coupling Rubber
30	12	SAT-7606230	Torque rubber
31	12	SAT-7606231	Torque rubber bolt and spring washer
32	12	SAT-7606232	Taper insert retaining ring (where Fitted)
33	12	SAT-7606233	Taper insert incl. No. 32 (where Fitted)
34	6	SAT-7606234	Magnetic Adapter (Ver. 4) incl. No.35
35	6	SAT-7606235	Magnetic Insert (Ver. 4)
36	2	SAT-7606236	Main disk
37	6	SAT-7606237	M10 Nut and Spring washer
38	1	SAT-7606238	Electrical Box Mount plate
39	1	SAT-7606239	Timer 0-3 sec
40	1	SAT-7606240	Reverse Switch (two Parts)
41	2	SAT-7606241	Large Weight MkII
42	2	SAT-7606242	Handle grip
43	2	SAT-7606243	Wheel Retaining bolt
44	2	SAT-7606244	Wheel
45	8	SAT-7606245	Wheel spacer
46	2	SAT-7606246	Ratchet Handle M12 Male
47	2	SAT-7606247	Hose 50mm Flex
48	4	SAT-7606248	Hose clamp 50mm S/S
49	1	SAT-7606249	Start stop switch silicone boot
50	1	SAT-7606250	Control box and lid
51	2	SAT-7606251	Contactor 12A 415volt
52	6	SAT-7606252	Nylon Gland M20
53	1	SAT-7606253	Main electrical Box and Lid only
54	6	SAT-7606254	Screws For Control Panel Box
55	1	SAT-7606255	Vacuum Tee



Floorex Products

'Your complete supplier
of all your concrete
surface preparation
needs'

- Diamond grinders
- Dust extraction
- Shotblasters
- Screed mixers
- Diamonds
- Floor Scrapers
- Coating application

FLOOREX
PRODUCTS
11 Jennings Road
Swan Hill VIC.
3585

Web: www.floorex.com.au
Email: sales@floorex.com.au